

Drum Core (CR Type)

1. Shape 形狀

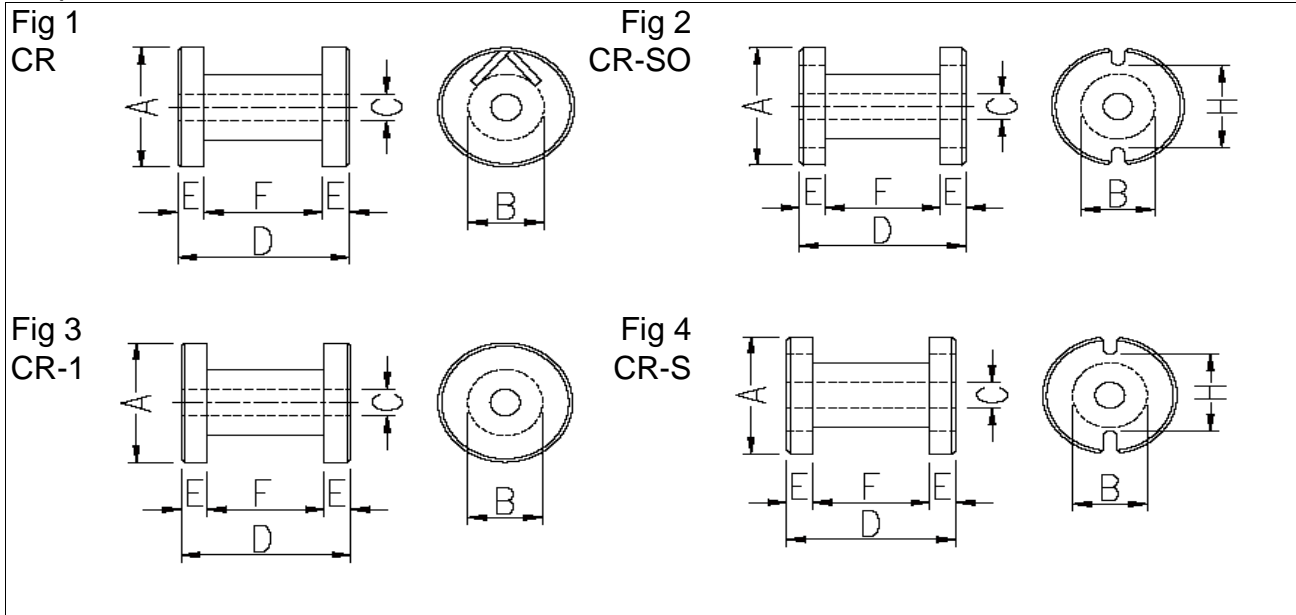

2. Ordering Code 編碼規則

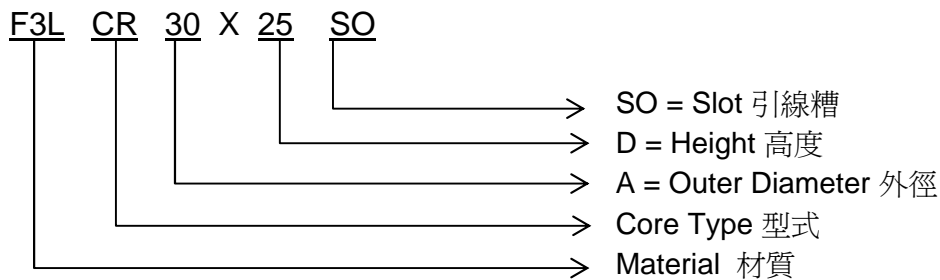

3. Dimensions 尺寸 (mm)

Core Size \ Conf.	A	B	C	D	E	F	Fig	Ref.
CR 14x15 S	14.0±0.5	6.2±0.3	2.2±0.3	15.0±1.0	2.5±0.3	10.0±0.5	4	Whole
CR 15.8x20 SO	15.8±0.5	10.0±0.3	4.0±0.3	20.0±1.0	3.75±0.3	12.5±0.6	2	Whole
CR 18.4x20	18.4±0.5	10.0±0.3	4.0±0.3	20.0±1.0	3.75±0.3	12.5±0.6	1	Joint
CR 20x18	20.0±0.5	10.0±0.3	5.2±0.3	18.0±1.0	3.5±0.3	11.0±0.6	1	Joint
CR 20x19 SO	20.0±0.5	10.0±0.3	5.2±0.3	19.0±1.0	4.0±0.3	11.0±0.6	1	Joint
CR 20x20	20.0±0.5	10.0±0.3	5.2±0.3	20.0±1.0	4.0±0.3	12.0±0.6	1	Joint
CR 20x25	20.0±0.5	9.8±0.3	5.2±0.3	25.0±1.0	4.0±0.3	17.0±0.8	1	Joint
CR 23x14	23.0±0.8	12.5±0.4	5.3±0.3	14.0±1.0	3.25±0.3	7.5±0.6	3	Joint
CR 23x16 SO	23.0±0.8	13.0±0.4	5.5±0.3	16.0±1.0	3.5±0.3	9.0±0.6	2	Joint
CR 23x18	23.0±0.8	13.0±0.4	5.5±0.3	18.0±1.0	3.5±0.3	11.0±0.6	1	Whole
CR 23x20	23.0±0.8	13.0±0.4	5.5±0.3	20.0±1.0	3.5±0.3	13.0±0.6	1	Joint
CR 23x20 S	23.0±0.8	15.2±0.4	5.3±0.3	20.0±1.0	3.0±0.3	14.0±0.6	4	Whole
CR 24.5x20 SO	24.5±0.8	13.0±0.4	5.5±0.3	20.0±1.0	3.5±0.3	14.0±0.6	2	Joint
CR 25x20	25.0±0.8	12.7±0.4	5.2±0.3	20.0±1.0	4.0±0.3	12.0±0.6	1	Joint
CR 25x20 SO	25.0±0.8	12.7±0.4	5.2±0.3	20.0±1.0	4.0±0.3	12.0±0.6	2	Joint

