

# SIZE ETD39

4 OUTPUT: 5+ 12v/5+ 12v

PIN 4 Removed  
PCB Hole Diameter=1.5mm

Part NO.	Output Power Maximum	Windings				Inductance (+/-10%)	Ambient Temperature	Frequency
			Pins	Voltage	Current Maximum			
SR-ED3901	140w	Pri	5-7	185-265Vrms	4Apeak	440 μH	<50°C	132KHZ
		Aux	3-2	7-14Vdc	0.5A dc			
		S1	14-15	3.3-6.5Vdc	5A dc			
		S2	13-15	8.5-17Vdc	5A dc			
		S3	11-12	3.3-6.5Vdc	5A dc			
		S4	10-12	8.5-17Vdc	5A dc			

## OUTLINE DIMENSIONS

## SCHEMATIC

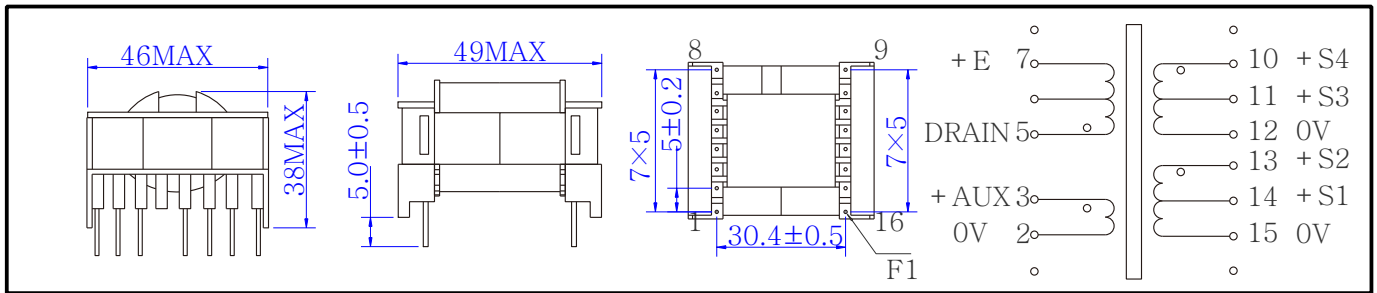

PIN 4 Removed PCB Hole Diameter=1.5mm

# SIZE ETD44

4 OUTPUT: 5+ 12v/5+ 12v

PIN 4 Removed  
PCB Hole Diameter=1.5mm

Part NO.	Output Power Maximum	Windings				Inductance (+/-10%)	Ambient Temperature	Frequency
			Pins	Voltage	Current Maximum			
SR-ED4401	180w	Pri	5-7	185-265Vrms	8Apeak	300 μH	<50 °C	60-132KHZ
		Aux	3-2	7-14Vdc	0.5A dc			
		S1	16-17	3.3-6.5Vdc	6A dc			
		S2	15-17	8.5-17Vdc	5A dc			
		S3	13-14	3.3-6.5Vdc	6A dc			
		S4	12-14	8.5-17Vdc	5A dc			

## OUTLINE DIMENSIONS

## SCHEMATIC

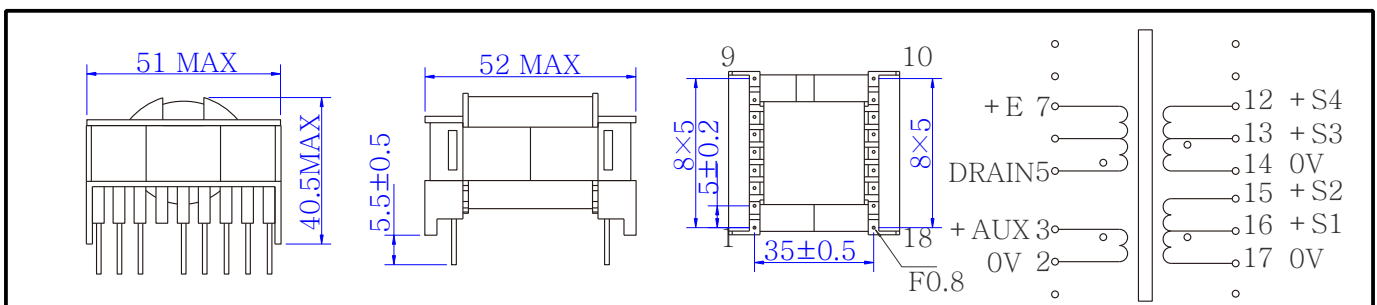

PIN 4 Removed PCB Hole Diameter=1.5mm



HEFEI SHIRUI ELECTRONIC TECHNOLOGY CO.,LTD

sales@shiruitech.com  
www.shiruitech.com