

貼片一體成型電感(圓線)

SRM0603A SERIES

PACKAGING DIMENSION: [Unit: mm]

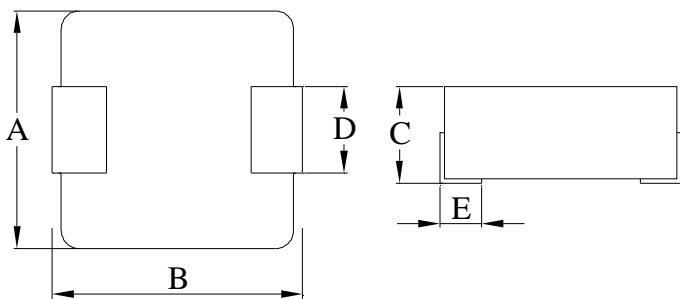

A	6.6 ± 0.3
B	7.2 ± 0.3
C	3.0 MAX
D	3.0 ± 0.3
E	1.6 ± 0.5

GENERAL SPECIFICATIONS:

**RoHS
COMPLIANT**

P/N	LO Inductance μH ±20% @0A	DCR (mΩ)		Heat Rating Current	Saturation Current
		[Typical]	[Max]	Idc (Amp)	Isat (Amp)
				Typical	Typical
SRM0603A-1R0M	1.0	7.6	8.0	12.5	9.5
SRM0603A-1R5M	1.5	11.7	12.5	10.5	8.0
SRM0603A-2R2M	2.2	15.7	16.5	9.0	7.0
SRM0603A-3R3M	3.3	24.8	26.0	7.0	6.5
SRM0603A-4R7M	4.7	31.8	33.4	6.0	4.0
SRM0603A-6R8M	6.8	44.6	46.8	5.5	4.0
SRM0603A-8R2M	8.2	52.3	54.9	5.0	4.0
SRM0603A-100M	10.0	67.8	71.2	4.0	3.5
SRM0603A-220M	22.0	128.9	135.0	2.9	2.5

⊙ All test Data is referenced to 25°C ambient

⊙ Typical Heat Rating DC Current would cause an approximately ΔT of 40°C

⊙ Typical Saturation DC Current would cause Lo to drop approximately 30%

△ Operating Temperature Range: -55°C to +125°C



HEFEI SHIRUI ELECTRONIC TECHNOLOGY CO.,LTD

Email:sales@shiruitech.com TEL:+0086-55165232650