

貼片一體成型電感(圓線)

SRM1770A SERIES

PACKAGING DIMENSION: [Unit: mm]

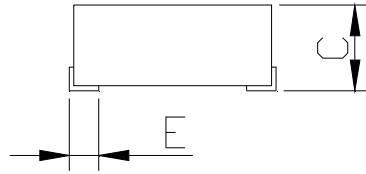
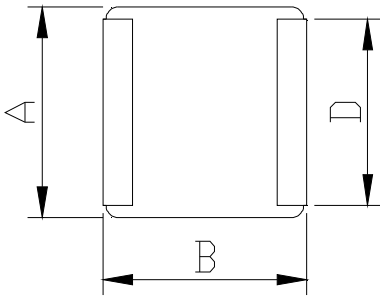

A	17.15 MAX
B	18.0 ± 0.3
C	7.0 MAX
D	11.94 ± 0.3
E	2.11 ± 0.3

GENERAL SPECIFICATIONS:

**RoHS
COMPLIANT**

P/N	LO Inductance μH ±20% @0A	DCR (mΩ)		Heat Rating Current	Saturation Current
		[Typical]	[Max]	Idc (Amp)	Isat (Amp)
				Typical	Typical
SRM1770A-R22M	0.22	0.63	0.70	80	129
SRM1770A-R33M	0.33	0.71	0.79	65	126
SRM1770A-R47M	0.47	0.84	0.92	62	123
SRM1770A-R56M	0.56	0.91	1.00	56	88
SRM1770A-R82M	0.82	1.17	1.29	50	73
SRM1770A-1R0M	1.0	1.28	1.35	48	73
SRM1770A-1R5M	1.5	1.78	1.88	42	65
SRM1770A-1R8M	1.8	1.96	2.07	38	65
SRM1770A-2R2M	2.2	2.40	2.53	35	62
SRM1770A-3R3M	3.3	3.68	3.88	28	54
SRM1770A-4R7M	4.7	4.84	5.11	25.0	41
SRM1770A-5R6M	5.6	6.68	7.05	21.0	40
SRM1770A-6R8M	6.8	8.4	8.83	19.0	32
SRM1770A-8R2M	8.2	10.1	10.66	18.0	25
SRM1770A-100M	10	11.6	12.0	16.5	25
SRM1770A-150M	15	18.8	19.9	12.5	25
SRM1770A-220M	22	25.1	26.5	11	23

⊙ All test Data is referenced to 25°C ambient

⊙ Typical Heat Rating DC Current would cause an approximately ΔT of 40°C

⊙ Typical Saturation DC Current would cause Lo to drop approximately 30%

△ Operating Temperature Range: -55°C to +125°C



HEFEI SHIRUI ELECTRONIC TECHNOLOGY CO.,LTD

Email:sales@shiruitech.com TEL:+0086-55165232650